



SPAIN-VALENCIA

EVENT INFO (V3)
12TH-14TH JUNE 2026

EVENT INFO_TRACK LOCATION



CIRCUIT NAME: Circuit Ricardo Tormo

TRACK LAYOUT: 3,100m FIA Grade 2 layout.

ADDRESS: Salida, Autovía del Este, 334, 46380 Cheste, Valencia, Spain.

Google maps: <https://maps.app.goo.gl/1fXyRAa7gNTbwF3z6>

TRACK ENTRANCE: [All teams will enter by ECO-2. As detailed in paddock map.](#)

HOLDING AREA FOR TRUCKS: Located in front of paddock restaurant.

Price:25€/day

If need, please refer to the Circuit Form: https://drive.google.com/file/d/14g4PzJv9fIiepgH6tGxbWkrk4Y_AGb/view?usp=share_link

Send back to susana.arino@tcr-series.com

Deadline: 7th June 2026

TEAMS ARRIVAL: Thursday 09:00-18:00.

DECLARATION OF TEAMS RADIOS: Kindly refer to Marisa Sanchez for that purpose marisa.sanchez@tecnitran.es

WAIVER: [Waivers must be submitted for the TEST. Please send by email to susana.arino@tcr-series.com](#)

| Thursday, 11th June | | | | | | | ↑ 08:34 ↓ 21:29 |
|---------------------|-------|-------|---|--------------------------|------------------------|----|-----------------|
| START | END | DUR | ACTIVITY | SESSION | LOCATION | TV | DRIFT TRACK |
| 09:00 | 10:00 | | Teams, Hospitality and tyre trucks arrival and set up | All categories | paddock and pits | | |
| 09:00 | 10:00 | | Pit boxes available | All categories | pits | | |
| 09:00 | 18:00 | | Track Banners' SET UP | | Track | | |
| 11:00 | 12:00 | | FIA Safety Training for scrutineering | FIA | drivers' briefing room | | |
| 13:00 | | | FIA Technical Scrutineering Meeting | FIA | Scrutineering area | | |
| 15:00 | | | FIA Race Control Meeting | FIA | Race Control | | |
| 16:00 | 19:00 | 03:00 | Technical Scrutineering | Kumho FIA TCR World Tour | | | |
| 17:30 | 19:30 | 02:00 | Track walk | All categories | | | |

| Friday, 12th June | | | | | | | ↑ 06:34 ↓ 21:29 |
|-------------------|-------|-------|---------------------------------|---|------------------------|----|-----------------|
| START | END | DUR | ACTIVITY | SESSION | LOCATION | TV | DRIFT TRACK |
| 08:00 | 09:00 | 01:00 | Track walk | All categories | paddock and pits | | |
| 08:00 | 12:00 | 04:00 | Technical Scrutineering | Kumho FIA TCR World Tour (with TCR Spain) | | | |
| 08:30 | 10:00 | 01:30 | Ad checks | Kumho FIA TCR World Tour (with TCR Spain) | | | |
| 09:00 | 12:00 | 03:00 | TCR TEST SESSION | all TCR cars | | | |
| 10:00 | 11:30 | 01:30 | Ad checks | Porsche Sprint Challenge Iberica | | | |
| 10:00 | 12:30 | 02:30 | Technical Scrutineering | Porsche Sprint Challenge Iberica | | | |
| 11:15 | 11:45 | 00:30 | Drivers' briefing | Porsche Sprint Challenge Iberica | drivers' briefing room | | |
| 11:45 | 12:15 | 00:30 | Briefing Team leaders | Porsche Sprint Challenge Iberica | drivers' briefing room | | |
| 12:00 | 14:30 | 02:30 | Technical Scrutineering | Spanish Copa Clio | | | |
| 12:45 | 13:15 | 00:30 | Drivers' briefing | Kumho FIA TCR World Tour (with TCR Spain) | drivers' briefing room | | |
| 13:15 | 13:30 | 00:15 | FIA Safety Training for drivers | Kumho FIA TCR World Tour (with TCR Spain) | drivers' briefing room | | |
| 13:00 | 14:00 | 01:00 | Ad checks | Spanish Copa Clio | | | |
| 14:00 | 14:30 | 00:30 | Drivers' briefing | Spanish Copa Clio | drivers' briefing room | | |
| 14:00 | 14:30 | 00:30 | Extrication exercise | Kumho FIA TCR World Tour (with TCR Spain) | At team's pits | | |
| 14:00 | 15:30 | 01:30 | Free Practice | DriftSpain- SEMIPRO | Drift track | | |
| 14:20 | 14:50 | 00:30 | Free Practice 1 | Porsche Sprint Challenge Iberica | | | |
| 15:00 | 15:30 | 00:30 | Free Practice 1 | Kumho FIA TCR World Tour (with TCR Spain) | | | |
| 15:30 | 17:00 | 01:30 | Free Practice | DriftSpain- PRO | Drift track | | |
| 15:40 | 16:10 | 00:30 | Free Practice 1 | Spanish Copa Clio | | | |
| 16:20 | 16:50 | 00:30 | Free Practice 2 | Porsche Sprint Challenge Iberica | | | |
| 17:00 | 17:30 | 00:30 | Free Practice 2 | Kumho FIA TCR World Tour (with TCR Spain) | | | |
| 17:00 | 18:00 | 01:00 | Free Practice | DriftSpain- SEMIPRO | Drift track | | |
| 17:45 | 18:15 | 00:30 | Free Practice 2 | Spanish Copa Clio | | | |
| 18:00 | 19:00 | 01:00 | Free Practice | DriftSpain- PRO | Drift track | | |
| 18:50 | | | TCR Family picture | all TCR cars | starting grid | | |
| 19:30 | 20:15 | 00:45 | Drivers' briefing | DriftSpain | drivers' briefing room | | |



All rights reserved WSC Group

EVENT INFO_TIMETABLE V6



| Saturday, 13th June | | | | | | | 1 08:34 ↓ 21:29 |
|---------------------|----------|----------|--|---|---------------|----|-----------------|
| START | END | DUR | ACTIVITY | SESSION | LOCATION | TV | DRIFT TRACK |
| 08:20 | 08:50 | 00:30 | Track inspection and Safety car exercise | | | | |
| 08:30 | 09:30 | 01:00 | Official Practice | DriftSpain SEMIPRO | Drift track | | |
| 09:00 | 09:15 | 00:15 | Qualifying 1 | Porsche Sprint Challenge Iberica | | | |
| 09:25 | 09:40 | 00:15 | Qualifying - Q1 | Spanish Copa Clio | | | |
| 09:45 | 10:00 | 00:15 | Qualifying - Q2 | Spanish Copa Clio | | | |
| 09:30 | 10:30 | 01:00 | Official Practice | DriftSpain- PRO | Drift track | | |
| 10:10 | 10:25 | 00:15 | Qualifying 2 | Porsche Sprint Challenge Iberica | | ● | |
| 10:45 | 11:05 | 00:20 | Qualifying - Q1 | Kumho FIA TCR World Tour (with TCR Spain) | | ● | |
| 11:12 | 11:22 | 00:10 | Qualifying - Q2 | Kumho FIA TCR World Tour (with TCR Spain) | | ● | |
| 11:30 | 12:30 | 01:00 | PIT WALK ABOUT & JET CAR SHOW AT 12:10 | | | | |
| 11:30 | 13:30 | 02:00 | Qualifying | DriftSpain- SFMIPRO | Drift track | | |
| 12:40 | | | Pit lane open | Porsche Sprint Challenge Iberica | | ● | |
| 12:45 | | | Pit lane closed | Porsche Sprint Challenge Iberica | | ● | |
| 12:50 | | | 5 min board | Porsche Sprint Challenge Iberica | | ● | |
| 12:55 | 13:20 | 00:25 | Sprint Race 1 (20 min + 1 lap) | Porsche Sprint Challenge Iberica | | ● | |
| 13:30 | 13:45:00 | 00:15:00 | Podium Race 1 | Porsche Sprint Challenge Iberica | Paddock Stage | ● | |
| 13:30 | 14:00 | | break | | | | |
| 13:45 | 16:00 | 02:15 | Qualifying | DriftSpain- PRO | Drift track | | |
| 14:05 | | | Pit lane open | Spanish Copa Clio | | ● | |
| 14:10 | | | Pit lane closed | Spanish Copa Clio | | ● | |
| 14:15 | | | 5 min board | Spanish Copa Clio | | ● | |
| 14:20 | 14:50 | 00:30 | Race 1 (25 + 1 lap) | Spanish Copa Clio | | ● | |
| 15:00 | 15:15 | 00:15 | Podium Race 1 | Spanish Copa Clio | Paddock stage | ● | |
| 15:10 | | | Pit lane open | Porsche Sprint Challenge Iberica | | ● | |
| 15:15 | | | Pit lane closed | Porsche Sprint Challenge Iberica | | ● | |
| 15:20 | | | 5 min board | Porsche Sprint Challenge Iberica | | ● | |
| 15:25 | 15:50 | 00:25 | Sprint Race 2 (20 min + 1 lap) | Porsche Sprint Challenge Iberica | | ● | |
| 16:00 | 16:15:00 | 00:15:00 | Podium Race 2 | Porsche Sprint Challenge Iberica | Paddock Stage | ● | |
| 16:00 | 16:20 | 00:20 | FIA Track inspection | FIA | | | |
| 16:40 | | 00:10 | Pit lane open | Kumho FIA TCR World Tour | | ● | |
| 16:50 | | 00:05 | Pit lane closed | Kumho FIA TCR World Tour | | ● | |
| 16:55 | | 00:05 | 10 min board | Kumho FIA TCR World Tour | | ● | |
| 17:00 | | 00:05 | 5 min board | Kumho FIA TCR World Tour | | ● | |
| 17:05 | | 00:05 | GF Formation lap | Kumho FIA TCR World Tour | | ● | |
| 17:10 | 17:45 | 00:35 | Race 1 (30 min + 1 lap) | Kumho FIA TCR World Tour | | ● | |
| 18:00 | 18:30:00 | 00:30 | Paddock Podium Race 1 | Kumho FIA TCR World Tour (with TCR Spain) | Paddock Stage | ● | |
| 17:45 | 20:00 | 02:15 | Top 32 | DriftSpain PRO | Drift track | | |
| 18:00 | 19:00 | 01:00 | VIP Laps TBC | | | | |

All rights reserved WSC Group

EVENT INFO_TIMETABLE V6

| Sunday, 14th June | | | | | | | ↑ 06:33 ↓ 21:30 | |
|-------------------|----------|----------|---|---|---------------|----|-----------------|--|
| START | END | DUR | ACTIVITY | SESSION | LOCATION | TV | DRIFT TRACK | |
| 09:30 | 10:00 | 00:30 | Track inspection | | | | | |
| 09:00 | 09:15 | 00:15 | Warm up | DriftSpain SEMIPHO | Drift track | | | |
| 09:30 | 11:45 | 02:15 | Lap 16 | DriftSpain SEMIPHO | Drift track | | | |
| 10:15 | | | Pit lane open | Spanish Copa Clio | | | | |
| 10:20 | | | Pit lane closed | Spanish Copa Clio | | | | |
| 10:25 | | | 5 min board | Spanish Copa Clio | | | | |
| 10:30 | 11:00 | 00:30 | Race 2 (25 + 1 lap) | Spanish Copa Clio | | ● | | |
| 11:10 | 11:25:00 | 00:15:00 | Podium Race 2 | Spanish Copa Clio | Paddock Stage | ● | | |
| 11:05 | 11:20 | 00:15 | FIA track inspection | FIA | | | | |
| 11:25 | | 00:10 | PIT lane open | Kumho FIA TCR World Tour | | ● | | |
| 11:35 | | 00:05 | PIT lane closed | Kumho FIA TCR World Tour | | ● | | |
| 11:40 | | 00:05 | 10 min board | Kumho FIA TCR World Tour | | ● | | |
| 11:45 | | 00:05 | 5 min board | Kumho FIA TCR World Tour | | ● | | |
| 11:50 | | 00:05 | GF Formation lap | Kumho FIA TCR World Tour | | ● | | |
| 11:55 | 12:00 | 00:05 | Race 2 (30 min + 1 lap) | Kumho FIA TCR World Tour | | ● | | |
| 12:40 | 13:10:00 | 00:30 | Podium Podium Race 2 | Kumho FIA TCR World Tour (with TCR Spain) | Paddock Stage | ● | | |
| 12:30 | 12:45 | 00:15 | Warm up | DriftSpain- PRO | Drift track | | | |
| 12:45 | 13:55 | 01:10 | PIT WALK ABOUT & JET CAR SHOW at 13:35 | | | | | |
| 13:00 | 15:15 | 02:15 | Top 16 | DriftSpain- PRO | Drift track | | | |
| 14:00 | 14:30:00 | 00:30:00 | PODIUM | DriftSpain- VoRace | Paddock Stage | | | |
| 14:00 | | | Pit lane open | Porsche Sprint Challenge Iberica | | ● | | |
| 14:05 | | | Pit lane closed | Porsche Sprint Challenge Iberica | | ● | | |
| 14:10 | | | 5 min board | Porsche Sprint Challenge Iberica | | ● | | |
| 14:15 | 14:40 | 00:25 | Sprint Race 3 (20 min + 1 lap) | Porsche Sprint Challenge Iberica | | ● | | |
| 15:00 | Approx | | PIT lane open 10 min after last vehicle took chequered flag | Porsche Sprint Challenge Iberica | | ● | | |
| 15:05 | | | Pit lane closed | Porsche Sprint Challenge Iberica | | ● | | |
| 15:10 | | | 5 min board | Porsche Sprint Challenge Iberica | | ● | | |
| 15:15 | 15:40 | 00:25 | Sprint Race 4 (20 min + 1 lap) | Porsche Sprint Challenge Iberica | | ● | | |
| 15:50 | 16:10:00 | 00:20:00 | Podium Sprint Race 3 and Race 4 | Porsche Sprint Challenge Iberica | Paddock Stage | ● | | |
| 15:30 | 16:00 | 00:30 | FINALS | DriftSpain | Drift track | | | |
| 16:30 | 17:00 | 00:30 | FINAL PODIUM | DriftSpain | Paddock Stage | | | |
| 17:00 | 17:10 | 00:10 | PODIUM GYMKHANA | DriftSpain | Paddock Stage | | | |
| 16:10 | | 00:10 | PIT lane open | Kumho FIA TCR World Tour | | ● | | |
| 16:20 | | | PIT lane closed | Kumho FIA TCR World Tour | | ● | | |
| 16:25 | | 00:05 | 10 min board | Kumho FIA TCR World Tour | | ● | | |
| 16:30 | | 00:05 | 5 min board | Kumho FIA TCR World Tour | | ● | | |
| 16:35 | | 00:05 | GF Formation lap | Kumho FIA TCR World Tour | | ● | | |
| 16:40 | 17:15 | 00:35 | Race 3 (30 min + 1 lap) | Kumho FIA TCR World Tour | | ● | | |
| 17:25 | 17:50:00 | 00:15 | Podium Podium Race 3 | Kumho FIA TCR World Tour (with TCR Spain) | Paddock Stage | ● | | |
| 18:30 | | | ALL EXPO CAR PARADE (no racing cars) | | | | | |
| 22:00 | | | Pits and paddock clear | All categories | | | | |



All rights reserved WSC Group

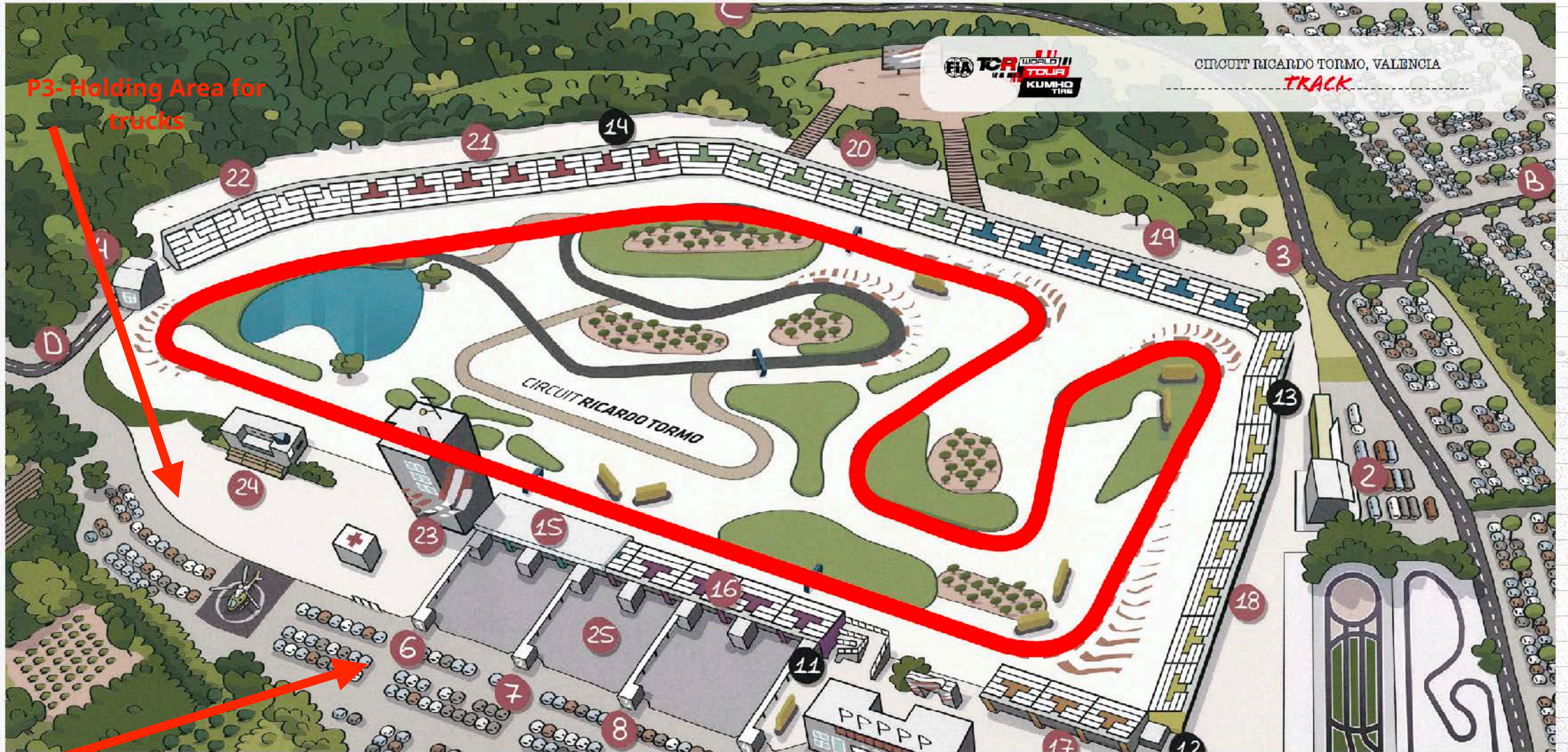

P3- Holding Area for trucks

Parking Teams / Staff

Private and Confidential

All rights reserved WSC Group

PASS SAMPLE BOARDS



FULL ACCESS RESERVED TO STAFF ONLY



ACCESS TO PADDOCK, PIT BOXES AND PIT LANE + TIMING, STEWARDS AND RACE DIRECTOR OFFICES



ACCESS TO PADDOCK, PIT BOXES, PIT LANE AND MEDIA CENTER.



LIMITED TO PADDOCK AREA ONLY



ACCESS TO PADDOCK, PIT BOXES AND PIT LANE (Specific Event)



LIMITED TO PADDOCK AREA ONLY



PIT LANE STICKER EXCLUSIVELY FOR PADDOCK AND VIP PASSES TO GRANT ACCESS TO THE PIT LANE.

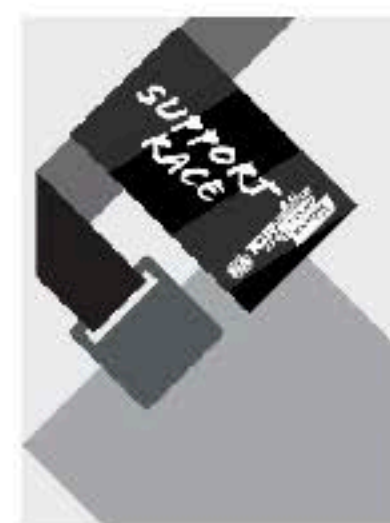

SUPPORT RACE STICKER COMPLEMENT FOR PIT LANE / PADDOCK PASSES FOR CATEGORIES OTHER THAN THE FIA TCR WORLD TOUR.



FULL ACCESS



FULL ACCESS

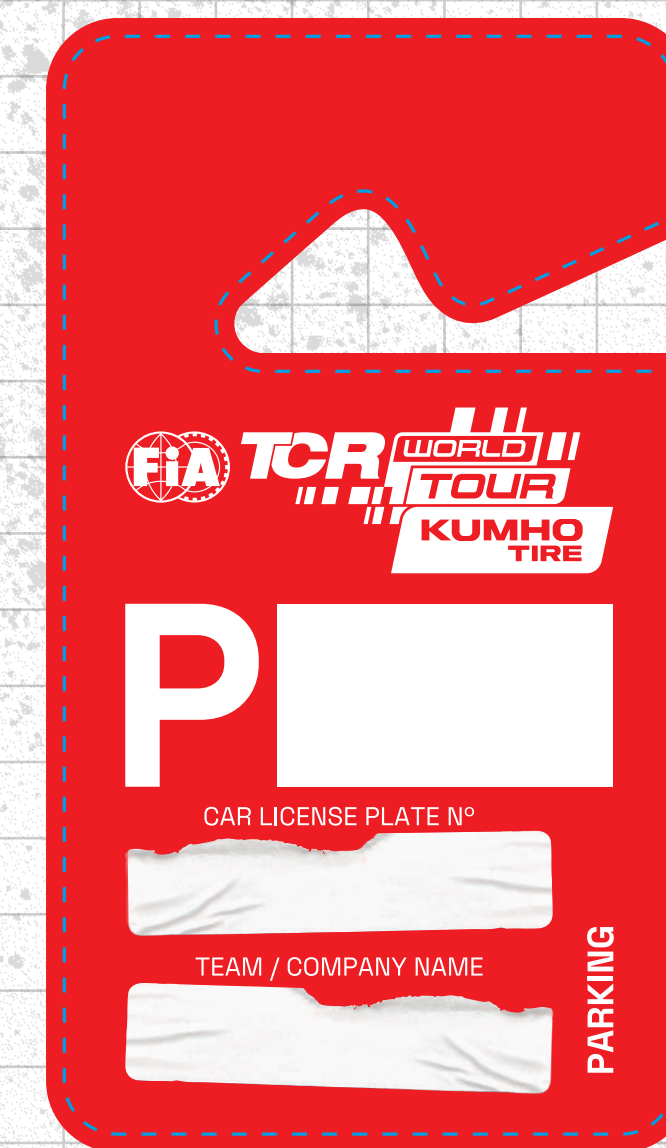

n.3 per entered car

All rights reserved WSC Group

| PASSES | | | ACESSES | | | | | | | | | | | | | | | | | | | | | | | | | | | | | | | | | |
|----------------------------|---|----------------------|---|-------------------------------------|-----------|-------------------------------------|-----------|-------------------------------------|----------|-------------------------------------|-------|-------------------------------------|---------|-------------------------------------|---------|-------------------------------------|------------|-------------------------------------|---------------------|--|----------|-------------------------------------|--|--|----------|-------------------------------------|--|--|-----|-------------------------------------|---------|-------------------------------------|--|--|--|--|
| <p>ORGANIZATION</p> | <p>TEAM MANAGER</p> | <p>DRIVER</p> | <p>ALL ACCESS</p> <table border="1"> <tr> <td>PIT WALL</td><td><input checked="" type="checkbox"/></td> <td>GRID LINE</td><td><input checked="" type="checkbox"/></td> </tr> <tr> <td>PIT LANE</td><td><input checked="" type="checkbox"/></td> <td>TOWER</td><td><input checked="" type="checkbox"/></td> </tr> <tr> <td>BOX</td><td><input checked="" type="checkbox"/></td> <td>PADDOCK</td><td><input checked="" type="checkbox"/></td> </tr> <tr> <td>TRACK</td><td><input checked="" type="checkbox"/></td> <td>PRESS ROOM</td><td><input checked="" type="checkbox"/></td> </tr> </table> | | PIT WALL | <input checked="" type="checkbox"/> | GRID LINE | <input checked="" type="checkbox"/> | PIT LANE | <input checked="" type="checkbox"/> | TOWER | <input checked="" type="checkbox"/> | BOX | <input checked="" type="checkbox"/> | PADDOCK | <input checked="" type="checkbox"/> | TRACK | <input checked="" type="checkbox"/> | PRESS ROOM | <input checked="" type="checkbox"/> | | | | | | | | | | | | | | | | |
| PIT WALL | <input checked="" type="checkbox"/> | GRID LINE | <input checked="" type="checkbox"/> | | | | | | | | | | | | | | | | | | | | | | | | | | | | | | | | | |
| PIT LANE | <input checked="" type="checkbox"/> | TOWER | <input checked="" type="checkbox"/> | | | | | | | | | | | | | | | | | | | | | | | | | | | | | | | | | |
| BOX | <input checked="" type="checkbox"/> | PADDOCK | <input checked="" type="checkbox"/> | | | | | | | | | | | | | | | | | | | | | | | | | | | | | | | | | |
| TRACK | <input checked="" type="checkbox"/> | PRESS ROOM | <input checked="" type="checkbox"/> | | | | | | | | | | | | | | | | | | | | | | | | | | | | | | | | | |
| <p>ASSISTANT</p> | <p>SPONSOR</p> | <p>VIP</p> | <p>ACCESS</p> <table border="1"> <tr> <td>PIT WALL</td><td><input checked="" type="checkbox"/></td> <td>GRID LINE</td><td><input checked="" type="checkbox"/></td> </tr> <tr> <td>PIT LANE</td><td><input checked="" type="checkbox"/></td> <td></td><td></td> </tr> <tr> <td>BOX</td><td><input checked="" type="checkbox"/></td> <td>PADDOCK</td><td><input checked="" type="checkbox"/></td> </tr> <tr> <td></td><td></td> <td></td><td></td> </tr> </table> | | PIT WALL | <input checked="" type="checkbox"/> | GRID LINE | <input checked="" type="checkbox"/> | PIT LANE | <input checked="" type="checkbox"/> | | | BOX | <input checked="" type="checkbox"/> | PADDOCK | <input checked="" type="checkbox"/> | | | | | | | | | | | | | | | | | | | | |
| PIT WALL | <input checked="" type="checkbox"/> | GRID LINE | <input checked="" type="checkbox"/> | | | | | | | | | | | | | | | | | | | | | | | | | | | | | | | | | |
| PIT LANE | <input checked="" type="checkbox"/> | | | | | | | | | | | | | | | | | | | | | | | | | | | | | | | | | | | |
| BOX | <input checked="" type="checkbox"/> | PADDOCK | <input checked="" type="checkbox"/> | | | | | | | | | | | | | | | | | | | | | | | | | | | | | | | | | |
| | | | | | | | | | | | | | | | | | | | | | | | | | | | | | | | | | | | | |
| <p>PRESS</p> | <p>ACCESS</p> <table border="1"> <tr> <td>PIT WALL</td><td><input checked="" type="checkbox"/></td> <td>GRID LINE</td><td><input checked="" type="checkbox"/></td> </tr> <tr> <td>PIT LANE</td><td><input checked="" type="checkbox"/></td> <td></td><td></td> </tr> <tr> <td>BOX</td><td><input checked="" type="checkbox"/></td> <td>PADDOCK</td><td><input checked="" type="checkbox"/></td> </tr> <tr> <td>TRACK</td><td><input checked="" type="checkbox"/></td> <td>PRESS ROOM</td><td><input checked="" type="checkbox"/></td> </tr> </table> | | PIT WALL | <input checked="" type="checkbox"/> | GRID LINE | <input checked="" type="checkbox"/> | PIT LANE | <input checked="" type="checkbox"/> | | | BOX | <input checked="" type="checkbox"/> | PADDOCK | <input checked="" type="checkbox"/> | TRACK | <input checked="" type="checkbox"/> | PRESS ROOM | <input checked="" type="checkbox"/> | <p>GUEST</p> | <p>ACCESS</p> <table border="1"> <tr> <td>PIT WALL</td><td><input checked="" type="checkbox"/></td> <td></td><td></td> </tr> <tr> <td>PIT LANE</td><td><input checked="" type="checkbox"/></td> <td></td><td></td> </tr> <tr> <td>BOX</td><td><input checked="" type="checkbox"/></td> <td>PADDOCK</td><td><input checked="" type="checkbox"/></td> </tr> <tr> <td></td><td></td> <td></td><td></td> </tr> </table> | PIT WALL | <input checked="" type="checkbox"/> | | | PIT LANE | <input checked="" type="checkbox"/> | | | BOX | <input checked="" type="checkbox"/> | PADDOCK | <input checked="" type="checkbox"/> | | | | |
| PIT WALL | <input checked="" type="checkbox"/> | GRID LINE | <input checked="" type="checkbox"/> | | | | | | | | | | | | | | | | | | | | | | | | | | | | | | | | | |
| PIT LANE | <input checked="" type="checkbox"/> | | | | | | | | | | | | | | | | | | | | | | | | | | | | | | | | | | | |
| BOX | <input checked="" type="checkbox"/> | PADDOCK | <input checked="" type="checkbox"/> | | | | | | | | | | | | | | | | | | | | | | | | | | | | | | | | | |
| TRACK | <input checked="" type="checkbox"/> | PRESS ROOM | <input checked="" type="checkbox"/> | | | | | | | | | | | | | | | | | | | | | | | | | | | | | | | | | |
| PIT WALL | <input checked="" type="checkbox"/> | | | | | | | | | | | | | | | | | | | | | | | | | | | | | | | | | | | |
| PIT LANE | <input checked="" type="checkbox"/> | | | | | | | | | | | | | | | | | | | | | | | | | | | | | | | | | | | |
| BOX | <input checked="" type="checkbox"/> | PADDOCK | <input checked="" type="checkbox"/> | | | | | | | | | | | | | | | | | | | | | | | | | | | | | | | | | |
| | | | | | | | | | | | | | | | | | | | | | | | | | | | | | | | | | | | | |



n.3 per entered car

All rights reserved WSC Group

PASES COPA CLIO Y CAMPEONATO de ESPAÑA de GT-CET



75 UNIDADES



200 UNIDADES



150 UNIDADES

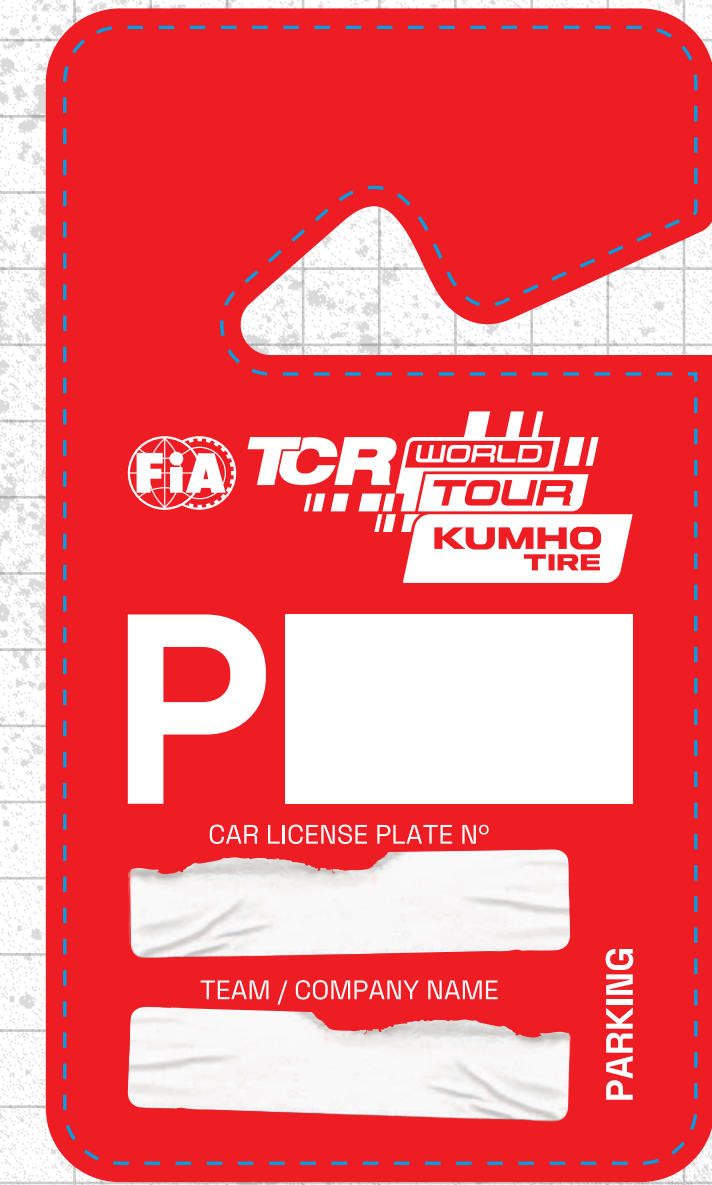

n.3 per entered car

All rights reserved WSC Group

IP1 ——— 1.037 m
IP1 - IP2 ——— 956 m
IP2 - START LINE — 1.143 m

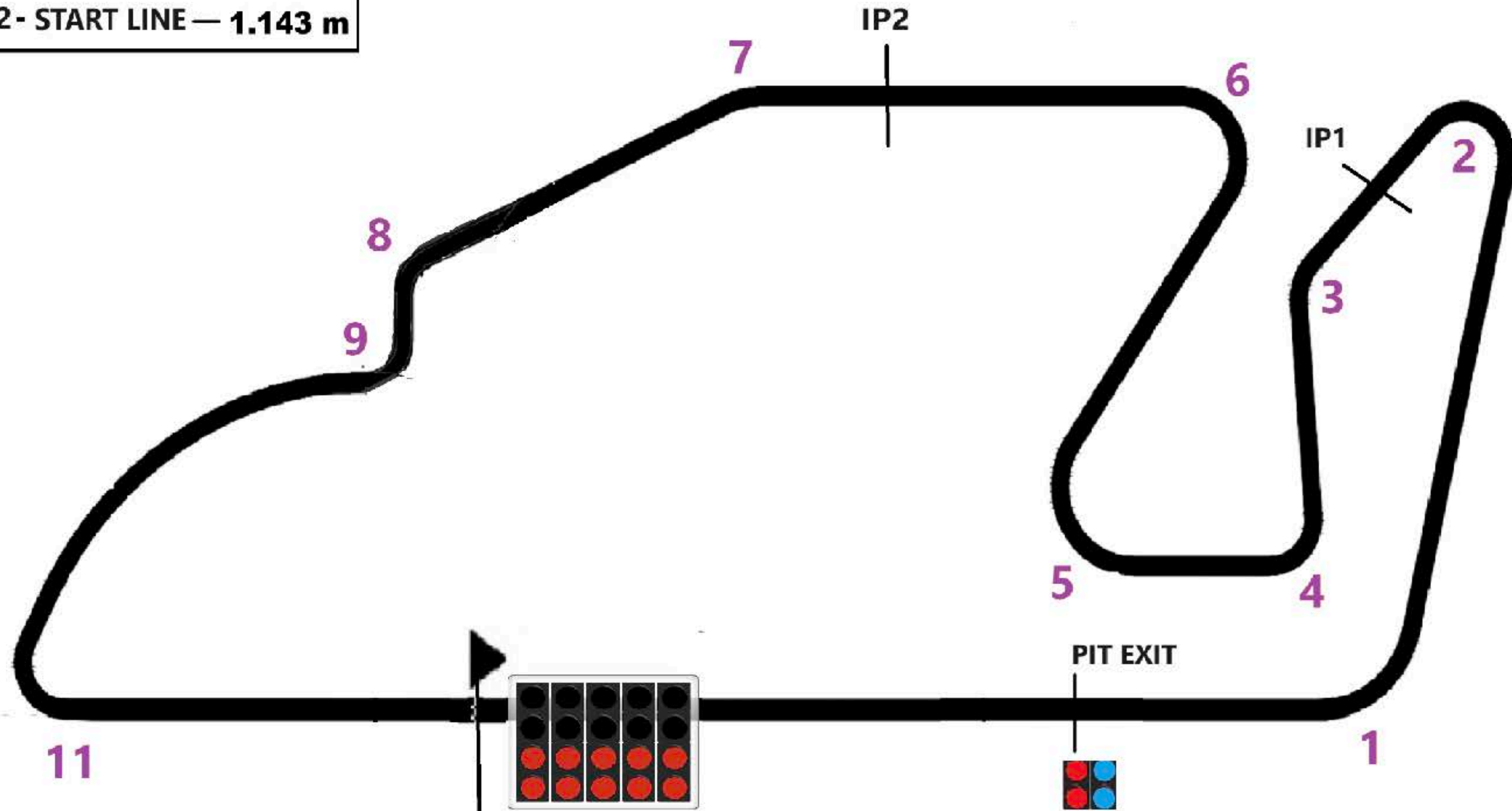

Length: 3,100m
FIA Homologated Grade 2

All rights reserved WSC Group

EVENT INFO_PIT FEATURES

BOX TIPO E 1/100

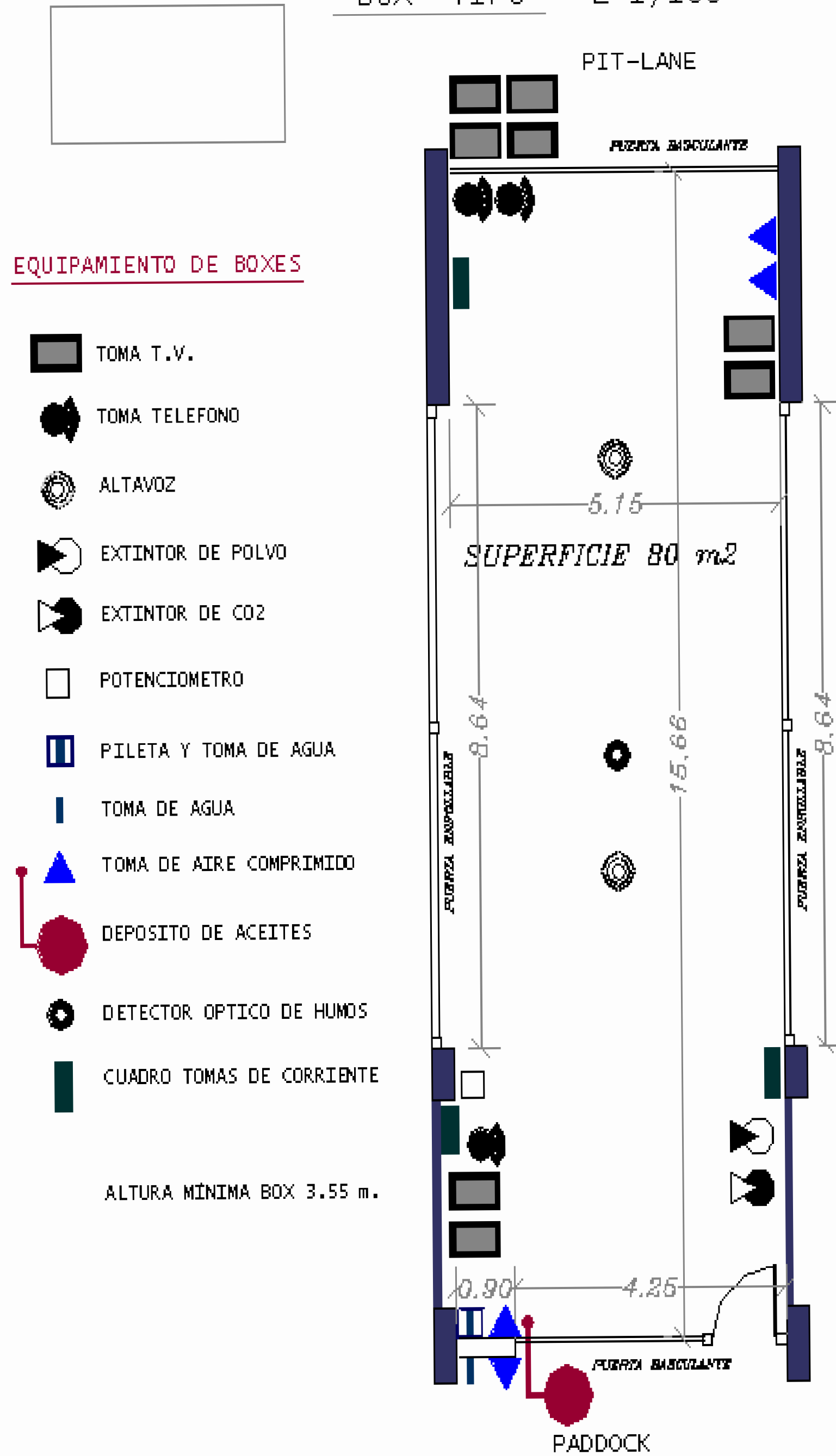

EQUIPAMIENTO DE BOXES

- TOMA T.V.
- TOMA TELEFONO
- ALTAVOZ
- EXTINTOR DE POLVO
- EXTINTOR DE CO2
- POTENCIOMETRO
- PILETA Y TOMA DE AGUA
- TOMA DE AGUA
- TOMA DE AIRE COMPRIMIDO
- DEPOSITO DE ACEITES
- DETECTOR OPTICO DE HUMOS
- CUADRO TOMAS DE CORRIENTE



All rights reserved WSC Group

EVENT INFO_PITS GENERAL INFO



ACCESS: From Thursday at 9 am. The entrance of the teams will be done by ECO-2 located in the parking area close to truck wash area. (marked in the paddock plan)

PIT ALLOCATION: FIA TCR WT Teams will get n. 1 pit box per entered car. The pit allocation V2 has been released.

KEYS: available with 100€ deposit **JUST CASH** at race office control tower ground floor after having the pit garages paid (400 euro- Cash or card).

RACE/ PADDOCK OFFICE OPENING TIMES:

Thursday: 09:00–19:00

Friday: 09:00–19:00

Saturday: 08:30–19:00

Sunday: 09:30–18:30

ELECTRICITY: Standard lights available + connection Live TV and timekeeping.

1 380V industrial Penta polar socket (the red one, 16 Amps or 32 Amps)

3 220V socket

WIFI: in the pits is available, but it's public and open to all paddock. For possible upgrade contact soporte@circuitricardotormo.com

SECURITY: General security of the circuit.

PADDOCK OPENING TIMES: Every day from 07.00 to 22:00

EVENT INFO_PROVISIONAL PIT ALLOCATION (V3)



| BOX | Category | Team | Car brand | CAR # |
|--|------------|-------------------------------|-----------|----------|
| BRIDGE 1 | | | | |
| 1 | FIA TCR WT | Stellar | | |
| 2 | FIA TCR WT | WVR | | |
| Clio Cup Scrutineering | | | | |
| 4 | FIA TCR WT | SPARF | | |
| 5 | FIA TCR WT | Vannin | Audi | 15 |
| 6 | FIA TCR WT | Vannin | Audi | 13 |
| 7 | FIA TCR WT | RX Pro Racing | Audi | 411 |
| 8 | FIA TCR WT | DSOEM Motorsport | Cupra | 419 |
| 9 | FIA TCR WT | Monlau | Cupra | 420 |
| 10 | FIA TCR WT | Monlau | Cupra | 10 |
| 11 | FIA TCR WT | Team Clairet | Audi | 481 |
| 12 | FIA TCR WT | Team Clairet | Cupra | 433 |
| 13 | FIA TCR WT | Team Clairet | Audi | 431 |
| 14 | FIA TCR WT | ALM | Honda | 441 |
| 15 | FIA TCR WT | AIM | Honda | 437 |
| 16 | FIA TCR WT | ALM | Honda | 405 |
| 17 | FIA TCR WT | ALM | Honda | 246 |
| 18 | FIA TCR WT | ALM | Honda | 121 |
| BRIDGE 2 | | | | |
| 19 | FIA TCR WT | RC2 / Goal | Honda | 186/ 473 |
| 20 | FIA TCR WT | SP Competition | Cupra | 472 |
| 21 | FIA TCR WT | SP Competition | Cupra | 169 |
| 22 | FIA TCR WT | SP Competition | Cupra | 107 |
| 23 | FIA TCR WT | Geely Cyan Racing | Geely | 186 |
| 24 | FIA TCR WT | Geely Cyan Racing | Geely | 155 |
| 25 | FIA TCR WT | Geely Cyan Racing | Geely | 111 |
| 26 | FIA TCR WT | Geely Cyan Racing | Geely | 168 |
| 27 | FIA TCR WT | JSB | Hyundai | 145 |
| 28 | FIA TCR WT | JSB | Hyundai | 24 |
| 29 | FIA TCR WT | Team Trico WRT | Hyundai | 81 |
| 30 | FIA TCR WT | SPARC | | |
| 31 | FIA TCR WT | BRC - Hyundai N Squadra Corse | Hyundai | 12 |
| 32 | FIA TCR WT | BRC - Hyundai N Squadra Corse | Hyundai | 105 |
| 33 | FIA TCR WT | BRC - Hyundai N Squadra Corse | Hyundai | 196 |
| 34 | | RTI-KUMHO | | |
| Porsche Sprint Challenge Iberica Scrutineering | | | | |
| 35 | PSCI | | | |
| BRIDGE 3 | | | | |
| 37 | PSCI | | | |
| 38 | PSCI | | | |
| 39 | PSCI | | | |
| 40 | PSCI | | | |
| 41 | PSCI | | | |
| 42 | PSCI | | | |
| 43 | PSCI | | | |
| 44 | PSCI | | | |
| 45 | PSCI | | | |
| 46 | PSCI | | | |
| 47 | PSCI | | | |
| 48 | IN/OUT | | | |
| BRIDGE 4 | | | | |



All rights reserved WSC Group

EVENT INFO_Paddock



TYRE SERVICE: RTI will be have [pit garage nr. 34](#) for their operations.

Opening times:

THURSDAY
11/06 **14:00 — 19:00**

FRIDAY
12/06 **09:00 — 19:00**

SATURDAY
13/06 **08:30 — 17:30**

SUNDAY
14/06 **09:00 — 16:00**

FUEL SERVICE: ETS distributor on site in charge of dispatching fuel drums as per orders placed [on Thursday at 11.00](#). Location TBA based on safety plan of the Circuit.

Order: https://www.myetstorace.com/products-for-races/?race_id=18884

Deadline: over

Paddock Rules: https://drive.google.com/file/d/19KqjSnP1qu1TC4Uif3nTlr7iU2L0v9Vs/view?usp=share_link

PARC FERMÉ: [At each teams' pit for the QP. Under paddock stage for the 3 first plus best RbR and best TCR Spain and at the circuit parc fermé for the rest of the cars for the races.](#)

All rights reserved WSC Group



TEAMS
THURSDAY
ENTRANCE



Control Tower Layout

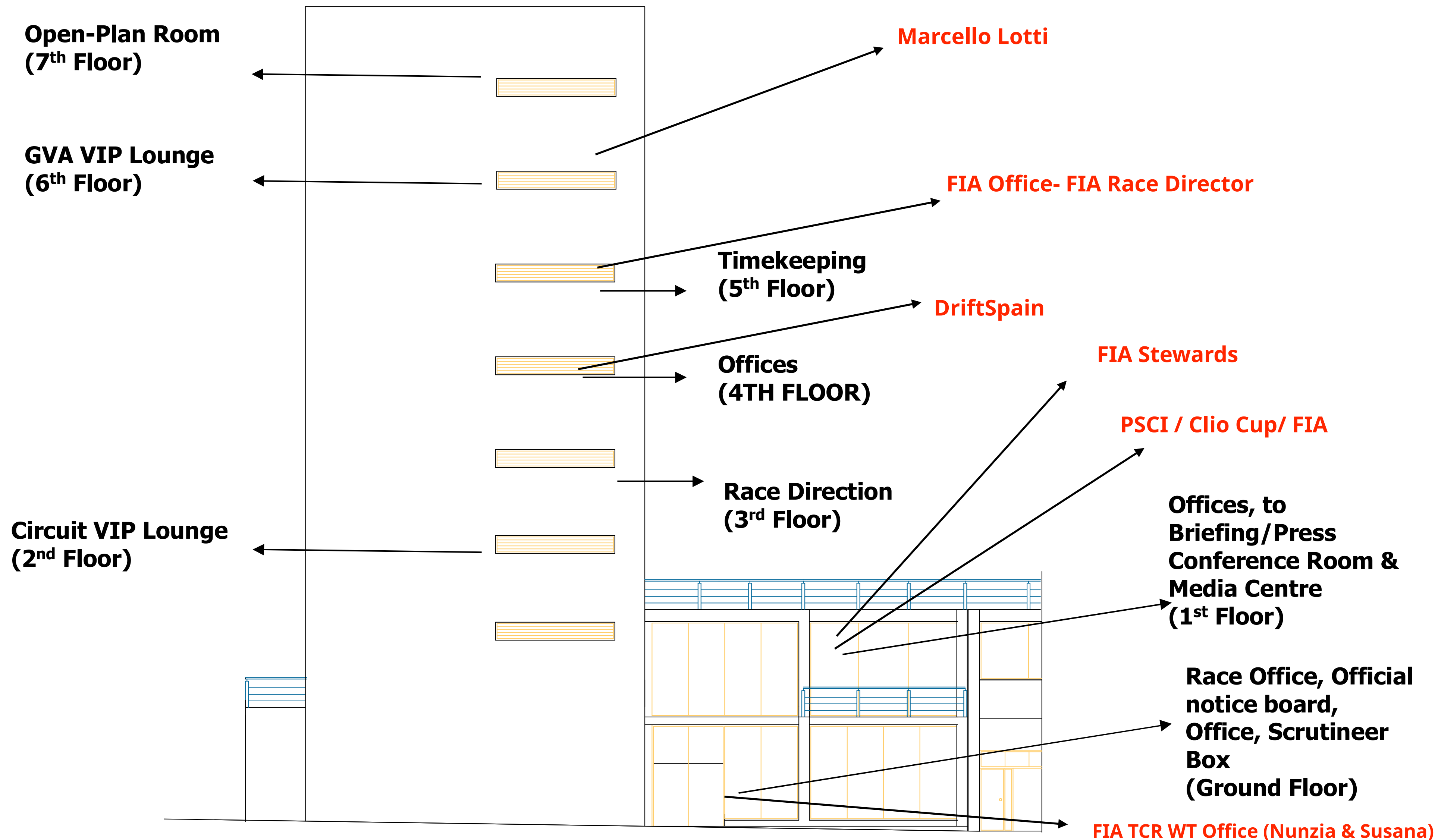

All rights reserved WSC Group

FIRST FLOOR

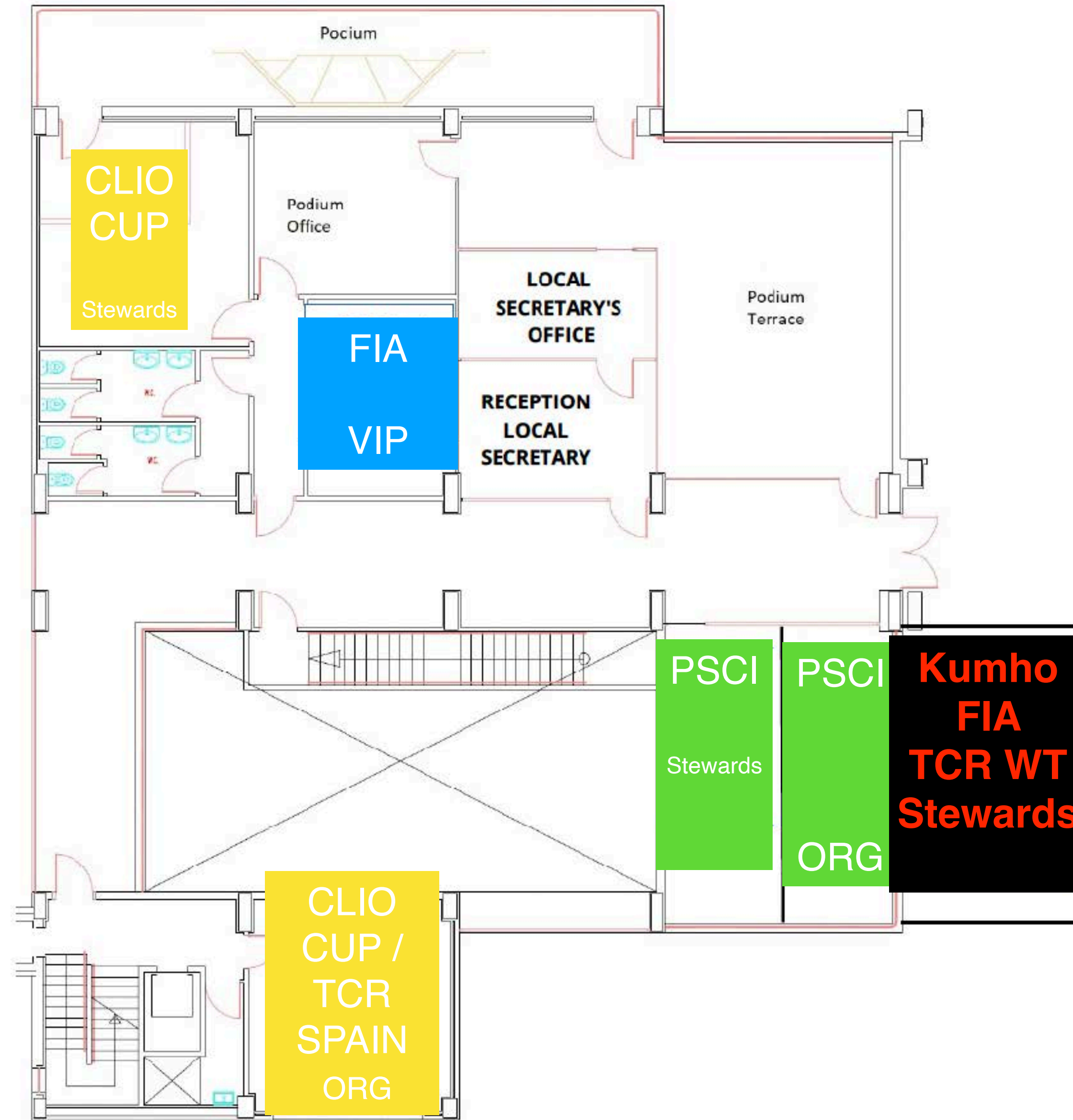

FOURTH FLOOR

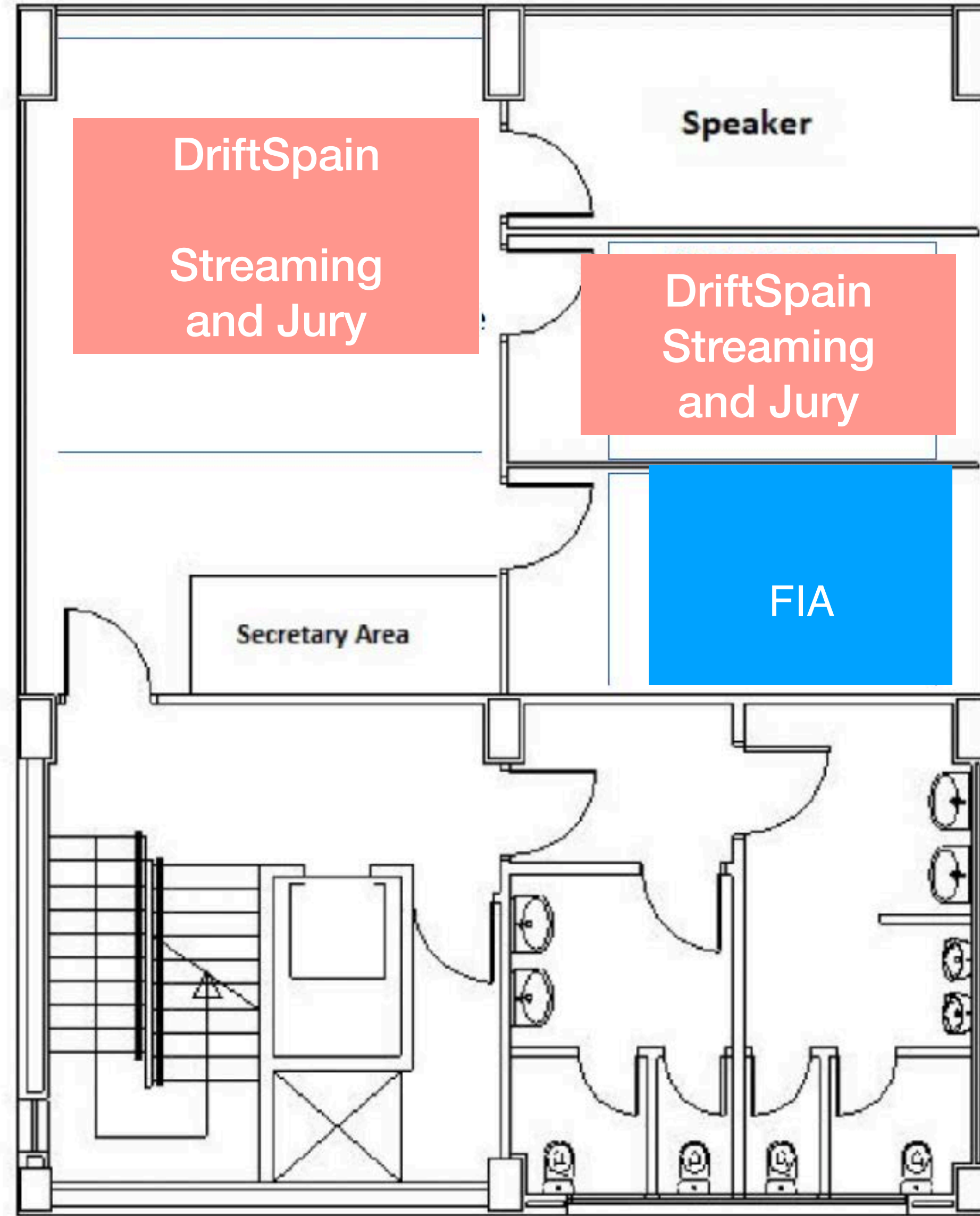

All rights reserved WSC Group

FIFTH FLOOR

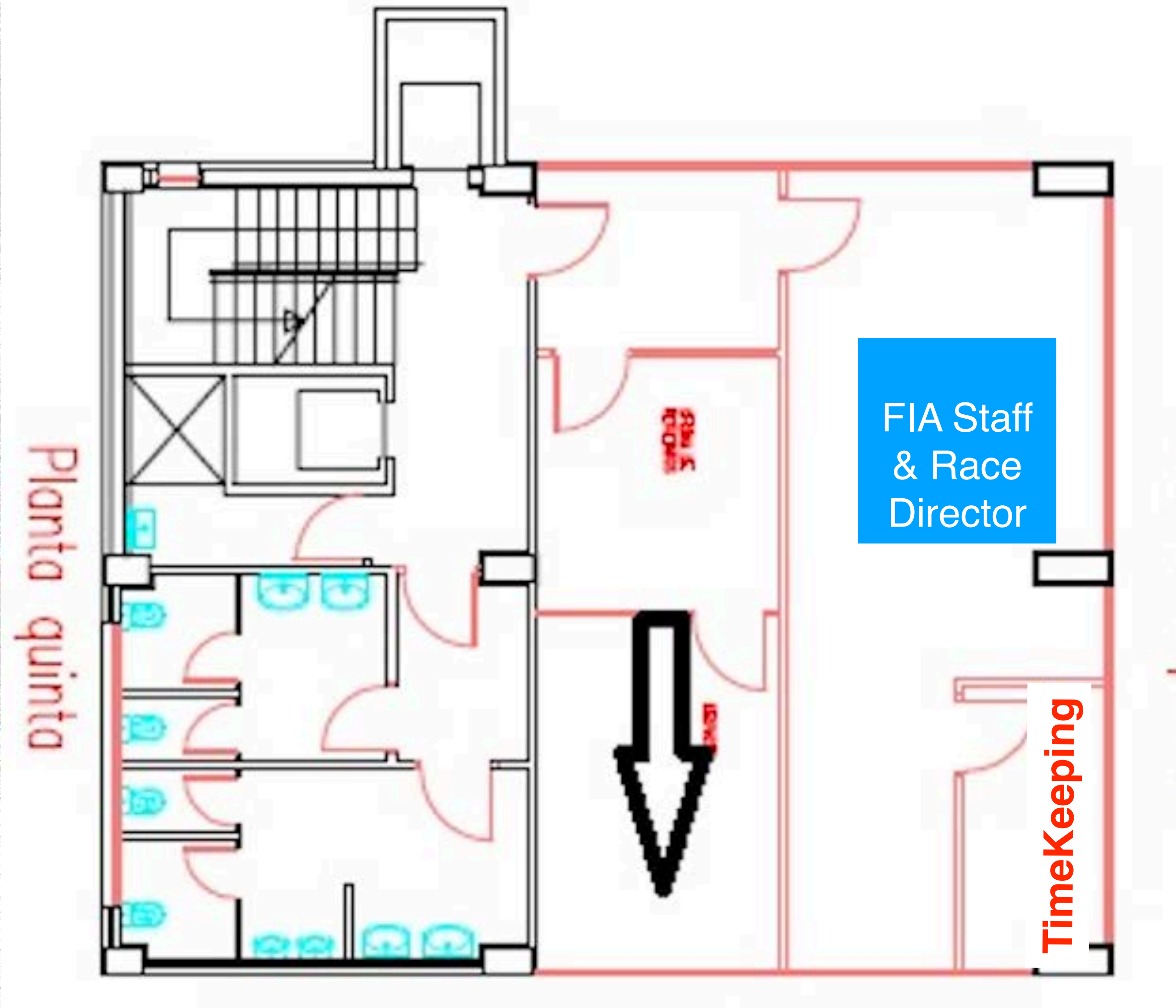

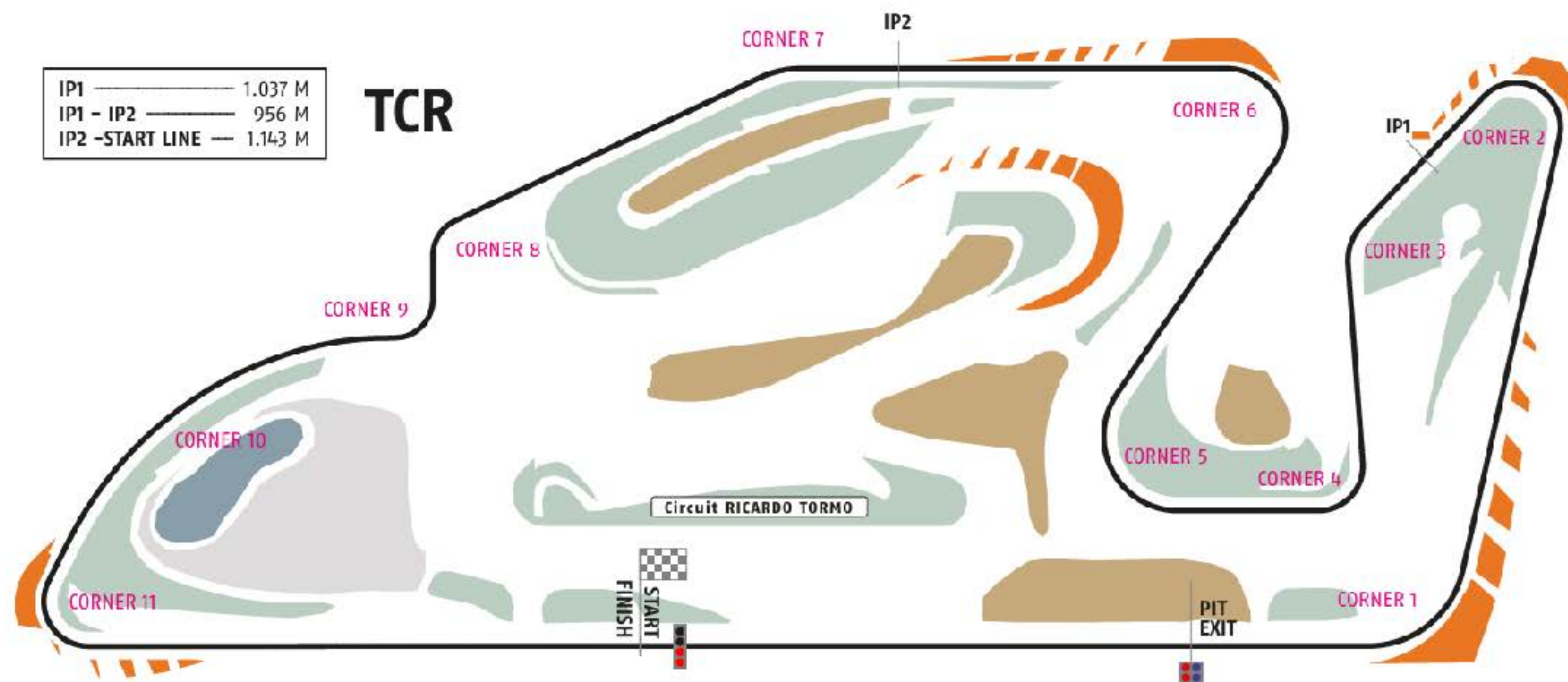

Timekeeping information:

Timekeeping done by TimeService

My laps transponders available by a rental fee of 100 euro.

Collection from Thursday Race office 9.00 to 19.00.

Transponders must be returned within 30' from the end of the latest scheduled race.

If Teams have their own transponder kindly communicate on Tuesday the 9th the latest.

All rights reserved WSC Group



Track Layout

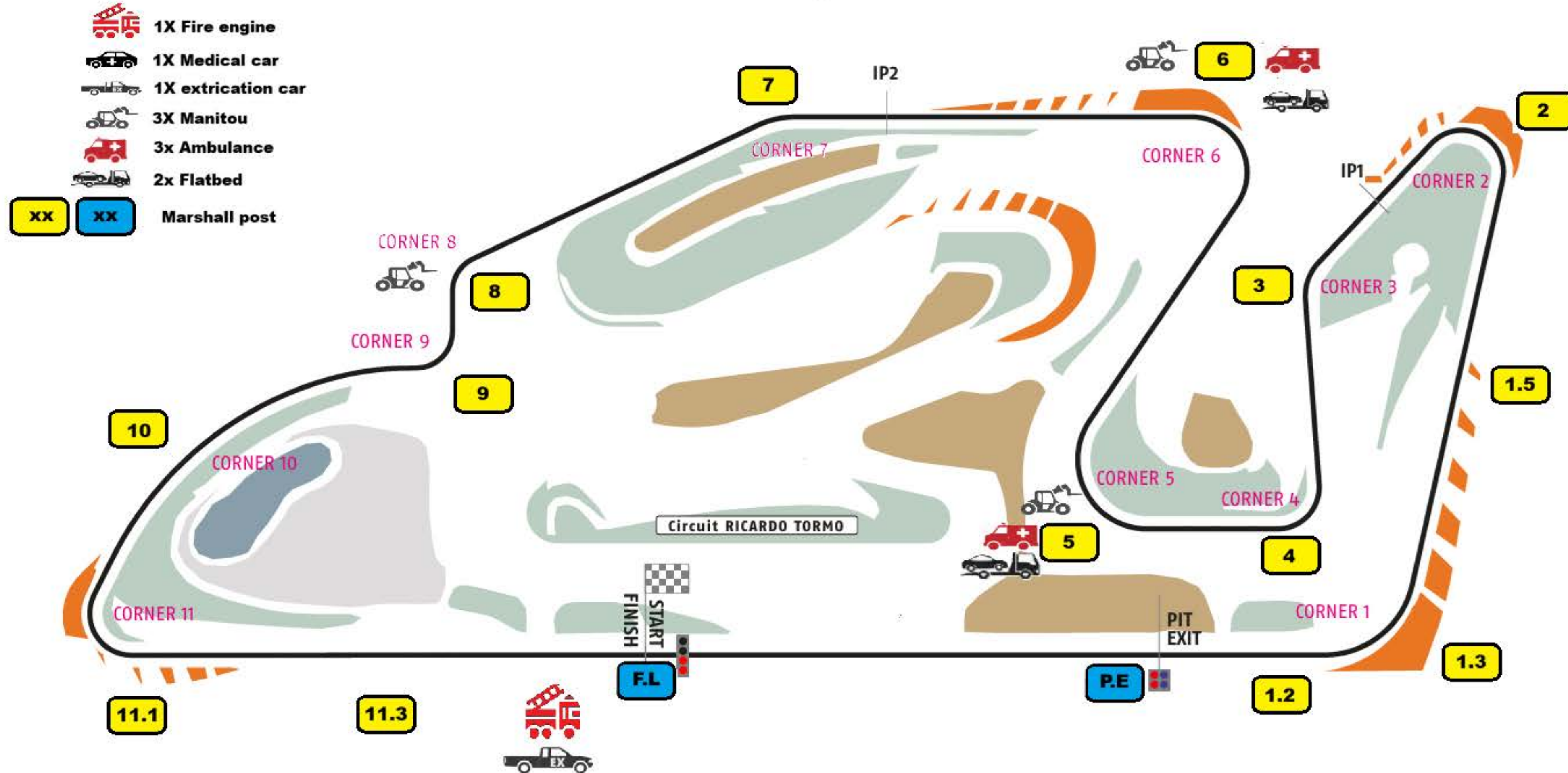

- 1X Fire engine
- 1X Medical car
- 1X extrication car
- 3X Manitou
- 3x Ambulance
- 2x Flatbed
- Marshall post

MEDICAL CENTER

All rights reserved WSC Group

FIA

Race Director: Dino LODOLA (ITA)

FIA Race Control Support: Tess HE (HPP)

Technical Delegate: Zoltan BALLA (HUN)

FIA Steward and Chair: Luís ROBY (PRT)

FIA Sporting Manager: Ksenia EM

FIA Sporting Staff: Marie TEISSIER

FIA Touring Car Commission Chair: Alan GOW

<https://fia-tcr-world-tour.vii-results.com/notice-board>

WSC

International Steward: Ramiro BRITO (PRT)

Technical Chief: Massimo GARBIN (ITA)

Data Delegate: Cinzia PIACQUADIO (ITA)

Driver Advisor: Alain MENU (BEL)

ASN (Rfeda)

National Steward: Esther Llobel (ESP)

Clerk of the Course: Gabriel BERRUGA (ESP)

EXTRICATION
Friday, 14.00 at team pit garage.
#10- Viktor Andersson (CUPRA)

EVENT INFO_OFFICIALS

CHAIRPERSON OF THE STEWARDS' PANEL – Jerónimo Cuerva –
Lic. - CD 0089-ESP/M

STEWARD – José Castanheira – Lic. – CDI PT 26 / 4956

CLERK OF THE COURSE – Carlos Lisboa – Lic – DP PT 26 / 0724

DEPUTY CLERK OF THE COURSE – Fátima Carrasqueira – Lic. – DP
PT 26 / 0606

SECRETARY TO THE STEWARDS – Gonçalo Filipe – Lic. – DC PT 26 /
4681

TECHNICAL SCRUTINEER PSCI – Dinis Mota – Lic. – CTC PT 26 /
5065

CHIEF SCRUTINEER – Manuel Franco – Lic. – CTC PT 26 / 5066

SCRUTINEER – Pedro Abreu – Lic. – CTC PT 26 / TBA

PSCI SECRETARIAT – Inês Teixeira – Lic. – AD PT 26 / 5253

SC DRIVER – Nadine Quintaneiro – Lic. – PT 26 / 4842

SC CO-DRIVER – Raquel Quintaneiro – AD Lic. PT 26 / 5058



RACE DIRECTOR: Neus Santamaría (DC0825-ESP/CAT)

Steward: Iván Font (CD0598-ESP/CV)

DEPUTY Race Director: Guillem Pérez (DC-1737-ESP/CAT)

SECRETARY: Mariona Zanini (SP-4327-ESP/CAT)

TECHNICAL DELEGATE: Roberto Cabal (JCT-2799-ESP/AS)

PODIUM: Manel Fonseca (PR-1741-ESP/CAT)

COPACLIO
ESPAÑA

THURSDAY

- **15:00 - 17:00 — Welcome Event** — Lounge above pits— All welcome (team kit / casual)
 - Live music (TBC)
 - Drinks & canapés
 - Table football activation
 - Social Media Interviews / game-show style content — Mikel Azcona, Santi Urrutia, Ma Qing hua
 - Spanish Cooking — Mikel Azcona, Santi Urrutia, Manel Fernandes
- **17:00 - 19:00 — Track Walk** — Circuit — All
 - Dedicated social media content plan & filming opportunities

FRIDAY

- **10:30 - 11:00 — Bumper Cars Activation** — Meet at stage — Jimmy Clairet, Ruben Volt, Aurelien Comte, Luke Sargeant
- **11:45 - 12:30 — Drifting Activation (collaboration)** — Drift track / gymkhana — Gabriele Covini, Jenson Brickley, Mikel Azcona, Thed Björk, Yann Ehrlacher, Viktor Andersson
- **12:45 — Drivers' Briefing** — Briefing Room — All
- **14:30 - 15:00 — Free Practice 1** — Circuit — All
- **15:45 - 16:00 — "Spanish Lessons" with Santi & Esteban** — On stage — international competitors (TBC)
- **17:00 - 17:30 — Free Practice 2** — Circuit — All
- **18:50 — TCR Family Picture** — Circuit — All
 - Social media & content opportunities immediately afterwards

SATURDAY

- **11:50 - 12:20 — Autograph Session** — Pitlane, in front of pitbox — All
- **12:30 - 12:50 — Spanish Lesson** — On stage — Santi Urrutia, Jenson Brickley, Jimmy Clairet, Luke Sargeant
- **After race — Podium** — On stage — Top 3 + ETS Trophy winner & fastest TCR Spain
- **After podium — Press Conference** — Backdrop at hospitality unit — Top 3 + ETS Trophy winner & fastest TCR Spain

SUNDAY

- **13:15 - 13:35 — Autograph Session** — Pitlane, in front of pitbox — All
- **14:00 - 14:15 — F1 Broadcast Commentary & Interview** — On stage — Mikel Azcona
- **14:30 - 14:45 — Arcade Antics** — Meet at stage — Jenson Brickley, Ruben Volt, Viktor Andersson, Jimmy Clairet
- **After race — Podium** — On stage — Top 3 + ETS Trophy winner & fastest TCR Spain
- **After podium — Press Conference** — Backdrop at hospitality unit — Top 3 + ETS Trophy winner & fastest TCR Spain

Please note that this is based on the Drivers agenda V5— Latest version loaded in the app will always apply.

All activities, timings, activations and driver appearances remain subject to confirmation and will be duly detailed in the final Promotional Activities Schedule and Drivers' Agenda.

EVENT INFO_SUPPORT RACES



EVENT INFO_TICKET ENTRANCE

<https://www.circuitricardotormo.com/eventos/tcr-volrace/>

<https://volrace.com/volrace-summer/>

€ 30 per one day

€40 per whole weekend

plus transaction fee

EVENT INFO_LINKS

Kumho FIA TCR WT Site: <https://www.fiacrworldtour.com/>

Circuit Ricardo Tormo Site: <https://www.circuitricardotormo.com/>



EVENT INFO_TEAM CATERING

Service Available:

Thursday

12:30 / 14:30 and 19:20 / 20:30

Friday

12:00 / 14:30 and 19:20 / 20:30

Saturday

12:00 / 14:30 and 19:20 / 20:30

Sunday

12:30 / 14:30

Pricing

- Price per menu: **30€ + VAT**

Orders

- Order form attached.

Deadline

- Final deadline to submit meal orders: **Over**

Location

Lounge in the main building

MENU 1

LUNCH

- Fresh Caprese salad with creamy mozzarella
- Spanish tortillas with onions
- Couscous with feta, cucumber, mint and lime
- Salad Bar

Stellar Signature Bowl

- Mediterranean Power Bowl – quinoa, chickpeas, cucumber, cherry tomatoes, olives, lemon dressing

Main Courses

- Spaghetti aglio, olio e peperoncino
- Oven-roasted chicken thighs

Warm Sides

- Rosemary-infused potatoes
- Grilled aubergines

Dessert

- Panna cotta with red berry coulis

Fresh Fruit Selection

- Seasonal fresh fruit selection

DINNER

- Rustic bruschetta with tomatoes and basil
- Shrimp and avocado salad with lime
- Farro salad with pesto and mozzarella pearls
- Salad Bar

Stellar Signature Bowl

- Thai Coconut Lime Bowl – jasmine rice, vegetables, light coconut curry, lime

Main Courses

- Amatriciana pasta with crispy pancetta
- Ham and cheese escalopes

Warm Sides

- Paprika-roasted potatoes
- Glazed carrots with sautéed spinach

Dessert

- Homemade apple cake

Fresh Fruit Selection

- Seasonal fresh fruit selection

MENU 2

LUNCH

- Freshly made pizza
- Chicken Caesar salad
- Cold pasta with cherry tomatoes, burrata and basil
- Salad Bar

Stellar Signature Bowl

- Poke Style Energy Bowl – basmati rice, avocado, edamame, crunchy vegetables, citrus dressing

Main Courses

- Creamy salmon pasta
- Slow-cooked pulled pork

Warm Sides

- Crispy roasted potatoes
- Green beans and broccoli

Dessert

- Chocolate panna cotta

Fresh Fruit Selection

- Seasonal fresh fruit selection

DINNER

- Rosemary focaccia
- Niçoise salad with tuna and fine vegetables
- Taboulé with fresh herbs
- Salad Bar

Stellar Signature Bowl

- Mediterranean Roasted Veg Bowl – grains, roasted summer vegetables, herbs

Main Courses

- Traditional Italian lasagna
- Grilled beef hamburgers and sausages

Warm Sides

- Creamy mashed potatoes
- Sweet garden peas

Dessert

- Pear and dark chocolate cake

Fresh Fruit Selection

- Seasonal fresh fruit selection

MENU 3

LUNCH

- Spanish potato and bacon tortilla
- Greek salad with feta
- Selection of Italian cold cuts
- Salad Bar

Stellar Signature Bowl

- Mexican Fuel Summer Bowl – basmati rice, black beans, corn, avocado, lime

Main Courses

- Pasta with ham, cream and peas
- Pork ribs glazed in BBQ sauce

Warm Sides

- Potato wedges
- Mixed sautéed vegetables

Dessert

- Classic crème caramel

Fresh Fruit Selection

- Seasonal fresh fruit selection

DINNER

- Focaccia with marinated olives
- Potato salad with crispy bacon
- Sweet melon with Parma ham
- Salad Bar

Stellar Signature Bowl

- Summer Lentil Power Bowl – basmati rice, lentils, roasted carrots, lemon herbs

Main Courses

- Pasta with fresh pesto and cherry tomatoes
- Aromatic chicken curry with basmati rice

Warm Sides

- Baked potato gratin
- Roasted zucchini with garlic and aromatic herbs

Dessert

- Warm chocolate crumble

Fresh Fruit Selection

- Seasonal fresh fruit selection

CAR LAYOUT 2026
RACE OF SPAIN

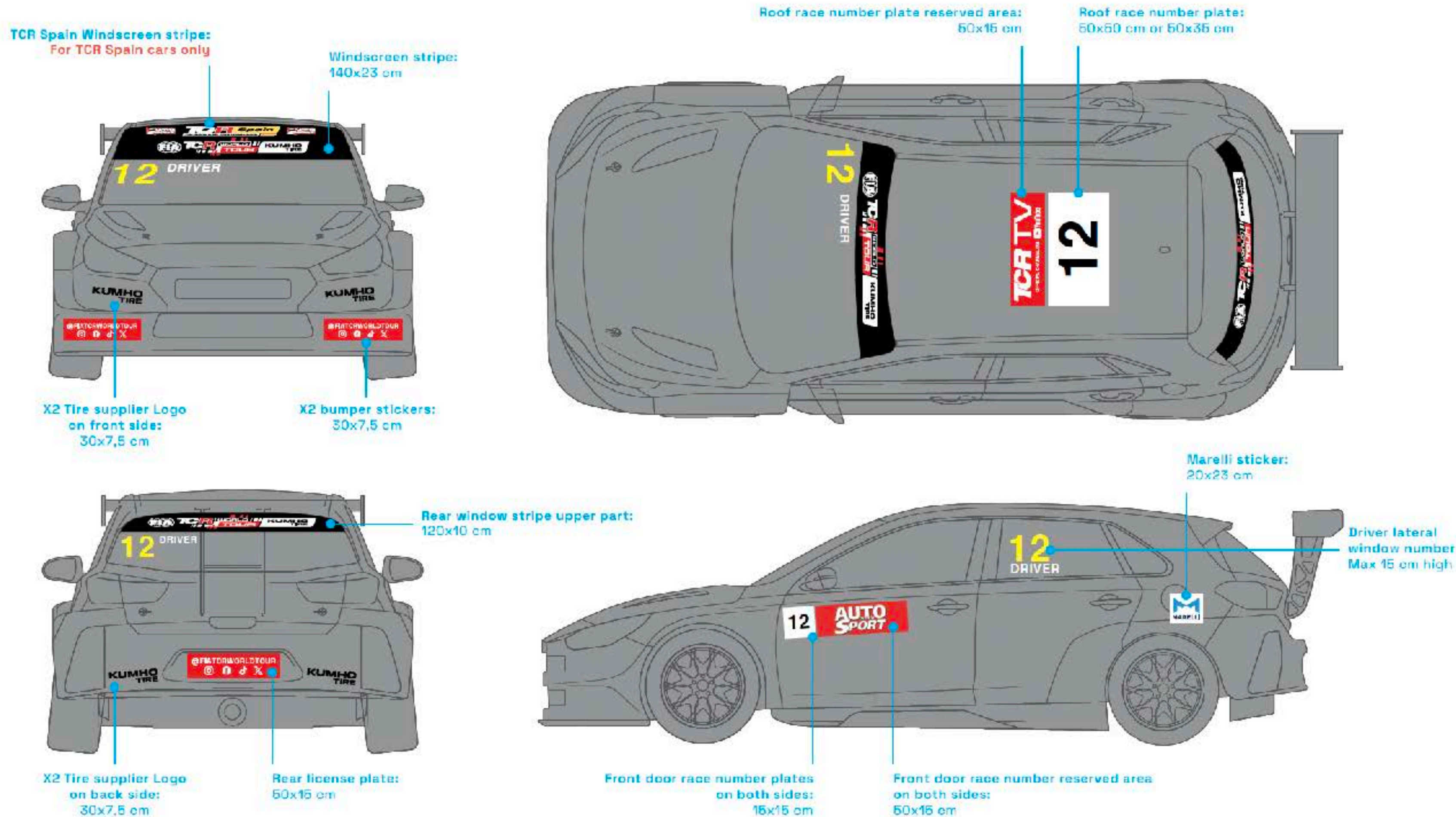

Official stickers will be available on site and delivered from Thursday with

- Passes
- Armband
- FIA TCR WT pins

All rights reserved WSC Group

EVENT INFO_ON BOARD CAMERAS INFORMATION

- # 107— Comte (Cupra)
- # 181 — Urrutia (Geely)
- # 196— Azcona (Hyundai)
- # 121— Clairet (Honda)

EVENT INFO_LIVE TV BROADCAST PLAN

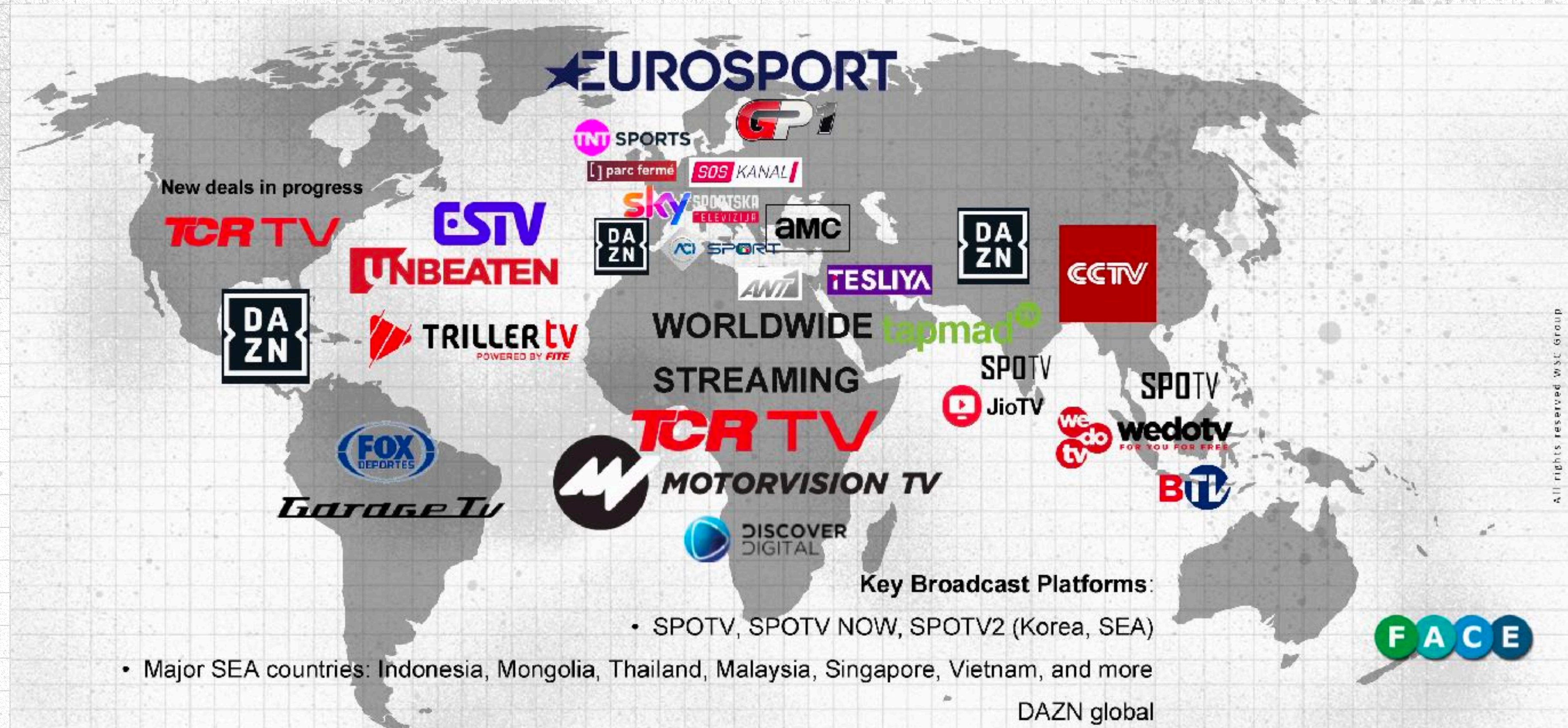

All rights reserved WSC Group

All rights reserved WSC Group

Key Broadcast Platforms:

- SPOTV, SPOTV NOW, SPOTV2 (Korea, SEA)
- Major SEA countries: Indonesia, Mongolia, Thailand, Malaysia, Singapore, Vietnam, and more

DAZN global

- Catering Form
- Waivers
- Holding Parking request
- Car Layout
- Pit allocation
- [Paddock map](#)
- [Drivers' promo agenda](#)

- Sporting forms available for the event (APP):
 - 1) Parc fermé neutralisation request.
 - 2) Declaration car controller.
 - 3) Declaration of drivers' equipment.
 - 4) Request to change turbo or engine.
 - 5) Request to be admitted to race.

- From Thursday afternoon team managers from WT can collect at FIA TCR WT office at ground floor Race control tower:
 - Personal passes
 - Parking passes
 - Radio set
 - Car controller armband
 - Car Stickers



THANK YOU!

2026